

# City of Alamo Heights



## *Lane Closure – Ellwood – Mon. February 1st through Tues. February 9th*

### **Scope of Work**

South lane of Ellwood between Ellwood Short and Fenimore will be closed beginning Monday, February 1<sup>st</sup> through Tuesday, February 9<sup>th</sup> daily from 7am to 6pm. Rampart Construction will be fixing portions of street paving as part of the Broadway/Ellwood project.

### **Traffic Impacts**

- South lane closed – Ellwood between Ellwood Short and Fenimore
- Monday, February 1<sup>st</sup> through Tuesday, February 9<sup>th</sup>
- Daily from 7am to 6pm

### *Map of Construction Areas*

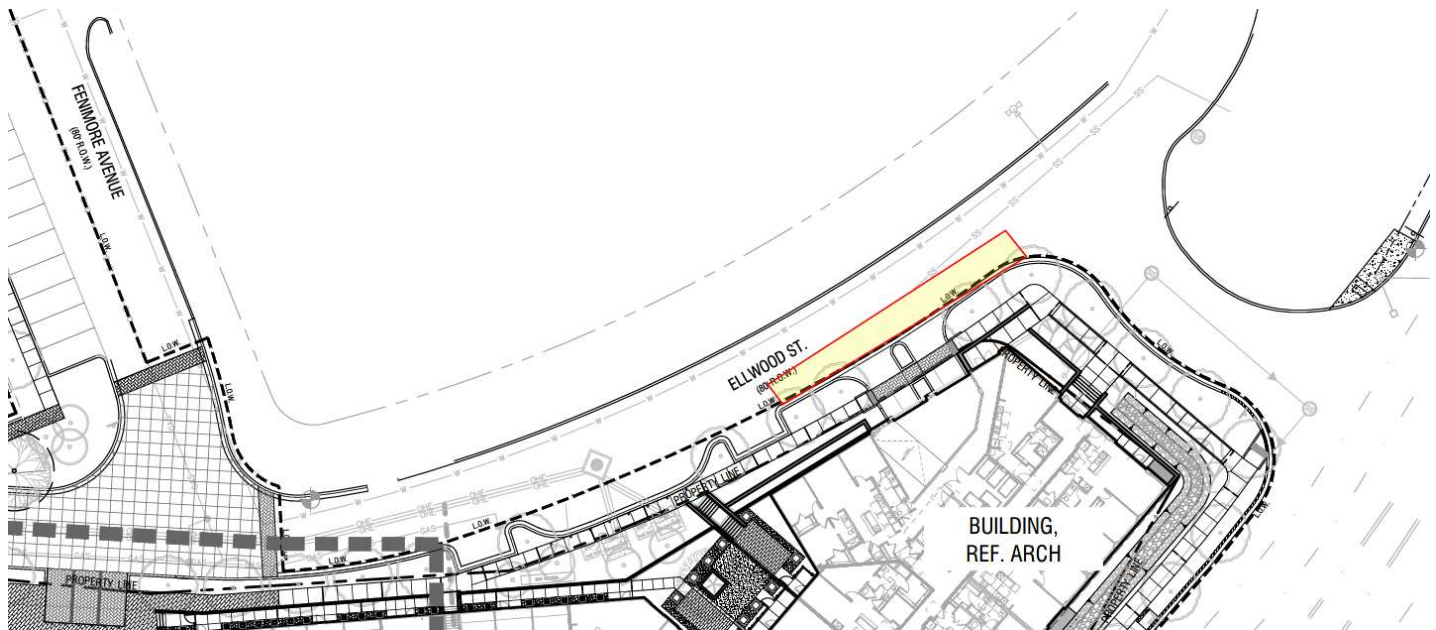

### **Outreach and Construction Contacts:**

#### **City of Alamo Heights**

Nina Shealey  
Director of Community Development  
210-832-2250  
[nshealey@alamoheightstx.gov](mailto:nshealey@alamoheightstx.gov)