



CITY OF ALAMO HEIGHTS
COMMUNITY DEVELOPMENT SERVICES DEPARTMENT
6116 BROADWAY
SAN ANTONIO, TX 78209
210-826-0516

Architectural Review Board Meeting
Tuesday, October 16, 2018 – 5:30 P.M.
6116 Broadway St – City Council Chambers

Case No. 726 F – 217 Oakview E

Request of Marquis (Alex) and Emily Whittington, owners, for the significance review of the existing main structure located at 217 Oakview E under Demolition Review Ordinance No. 1860 (April 12, 2010) in order to demolish 100% of the existing main structure and accessory structure.

Chapter 5 of Code of Ordinances (Buildings and Building Regulations) requires City Council to consider the ARB's recommendation for all demolition/final design review applications. Any recommendation will be forwarded to the City Council for final review. Please check the ARB posted results on the City's website after the ARB meeting to confirm any future meeting dates.

Plans may be viewed online* (<http://www.alamoheightstx.gov/departments/planning-and-development-services/public-notices/>), at the Community Development Services Department (6116 Broadway St), or you may contact Lety Hernandez (lhernandez@alamoheightstx.gov) or our office at (210) 826-0516 for additional information.

****Plans will not be available online for all case types and floor plans will not be available online.****

Property Address: 217 East Oakview Place		Architecture Type: N/A	
Original Architect: N/A		Year Built:	

Lot Coverage*	EXISTING Calculations (in sq. ft.)		PROPOSED Calculations (in sq. ft.)	
	Applicant	Staff	Applicant	Staff
Lot area	10,350		10,350	
Main house footprint	2,484		Ø	
Front porch	130		130	
Side porch 1	150		Ø	
Side porch 2				
Rear porch				
Garage footprint				
Carport footprint	360		Ø	
Shed footprint				
Breezeways				
Covered patio structure				
Other accessory structures				
Total (total lot coverage/lot area):	13,474		10,480	
Total Lot Coverage:	13,474		10,480	

Floor Area Ratio (FAR)**	EXISTING Calculations (in sq. ft.)		PROPOSED Calculations (in sq. ft.)	
	Applicant	Staff	Applicant	Staff
Lot area	10,350		10,350	
Main house: 1st floor	2,484		Ø	
Main house: 2nd floor				
Garage: 1st floor				
Garage: 2nd floor				
Other structures (unless exempted - see below)				
Total (total FAR/lot area):	12,834		10,350	
Total FAR:	12,834		10,350	
Height of Main Structure:	14'		Ø	

*Lot coverage is defined as the percentage of the total lot area covered by a roof, floor or other buildings excepting eaves. Carports, sheds, porches, covered pedestrian walkways, breezeways, arbors, gazebos and covered patios are included in lot coverage calculations (Exception: The maximum lot coverage shall exclude free-standing entryway arbors with open-air lattice framework under fifty (50) square feet in area and eight (8) feet in height, and other free-standing open-air lattice/trellis structures located within a side or rear yard up to twelve (12) feet in height, totaling three hundred (300) square feet or less and subject to other standards governing accessory structures.

**Floor area ratio (FAR) is defined as the ratio of the total above ground gross floor area of all structures on a site to the total square footage of a lot (for example, a FAR of .53 for a seven thousand five hundred (7,500) square foot lot is three thousand nine hundred seventy-five (3,975) gross square feet (.53 X 7,500) of floor area). The following areas shall be included when computing the gross floor area:

- (1) Exterior walls: The thickness of the wall shall be included in the calculation;
- (2) Above grade floor area: Any room that has a wall surface that extends more than three (3) feet above grade;
- (3) Laundry rooms, mechanical rooms, storage rooms, built-in cabinets and media niches;
- (4) Mezzanines and lofts;
- (5) Floor area used by stairways, elevators, escalators and similar features. The floor area of each run of stairs shall be counted once;
- (6) Vaulted ceilings: the floor area shall be counted at the actual floor area only and not in the air spaces;
- (7) Usable spaces (generally defined as having a five (5) foot minimum height) such as rooms, closets and cabinets under a run of stairs;
- (8) Exterior structures and additions with a solid roof and enclosed on more than two (2) sides in whole or part with permanent solid walls or windows such as porches, balconies, patios and breezeways;
- (9) Attached and detached garages and carports; and
- (10) Accessory buildings such as sheds, pool houses, guest houses, bonus rooms and second units.

The following areas shall not be included when computing the gross floor area:

- (1) Below grade floor area: any area that has a wall surface that extends less than three (3) feet above grade;
- (2) Porches, balconies, patios, breezeways, decks, overhangs, eaves, cantilevers and awnings with solid roof-like cover, but not enclosed on more than two (2) sides;
- (3) Porches, balconies, patios, breezeways and decks that do not have a solid roof-like cover; and
- (4) Attic space that is not habitable. If made habitable in the future, shall be included in floor area ratio.

Definitions as listed per City of Alamo Heights "Code of Ordinances" can be found at www.municode.com (Ch. 3 "Zoning," Sec. 3-2 "Definitions")

Property Address:

217 East Oakview Place

Total Impervious Cover Sq. Ft. for Stormwater Development Fee*	EXISTING Calculations (in sq. ft.)		PROPOSED Calculations (in sq. ft.)	
	Applicant	Staff	Applicant	Staff
Footprint of all structures	2,844		Ø	
Driveway/Parking Pad	1,575		1,575	
Walkways	415		180	
Swimming Pool/Spa				
Other impervious cover: _____				
Total impervious surface cover (in this project):	4,834		1,755	
Total impervious surface cover <u>removed/existing</u> (in this project):			64%	
Total impervious surface cover <u>sq. ft.</u> (proposed minus removed = net figure for this project)*			<3,079>	
Stormwater Development Fee*				

Impervious Surface Cover within front yard setback**	Applicant	Staff	Applicant	Staff
Front yard setback area	5,625		5,625	
Footprint of any structure(s)				
Driveway/Parking Pad	200		200	
Walkways				
Other impervious cover: _____				
Impervious surface cover within front yard setback in this project	200		200	
Impervious surface cover <u>removed/existing</u> within front yard setback in this project			Ø	
Impervious surface cover net proposed <u>sq. ft.</u> within front yard setback			200	
Impervious surface cover proposed within front yard setback			B / A	B / A
Maximum 30% allowed for SF-A and SF-B Districts			4.5%	

*The stormwater development fee shall be equivalent to the net additional square footage of total impervious surface area (excluding public sidewalks) of the property multiplied by \$0.40.

Exemptions. The following real property, only, shall be exempt from the provisions of this section:

- (1) Property owned by the City of Alamo Heights and/or dedicated to right-of-way for public streets and/or to provide drainage service; and
- (2) Property with proper construction and maintenance of a privately owned drainage or stormwater system wholly sufficient to provide all the drainage or stormwater service for that property.

**Depending on property's zoning district, the maximum impervious surface allowed within the front yard setback area is 30% (per Sec. 3-18) and 40% (per Sec. 3-50; please refer to Code for other regulations).

Impervious cover. Ground surfaces including concrete or paved driveways, sidewalks, parking lots, building and other improvements that resist the infiltration of water, thereby resulting in water runoff. Impervious cover includes any surface material or surface treatment or surface condition which sheds fifty (50) percent or more of rainfall, or water, which falls on it.

City of Alamo Heights "Code of Ordinances" can be found at www.municode.com (Ch. 3 "Zoning," Sec. 3-18, Sec. 3-50; Ch. 13 "Storm Drainage," Sec. 13-29 "Stormwater development fee" and Sec. 13-1 "Definitions").

217 East Oakview- Existing Conditions 9.17.2018

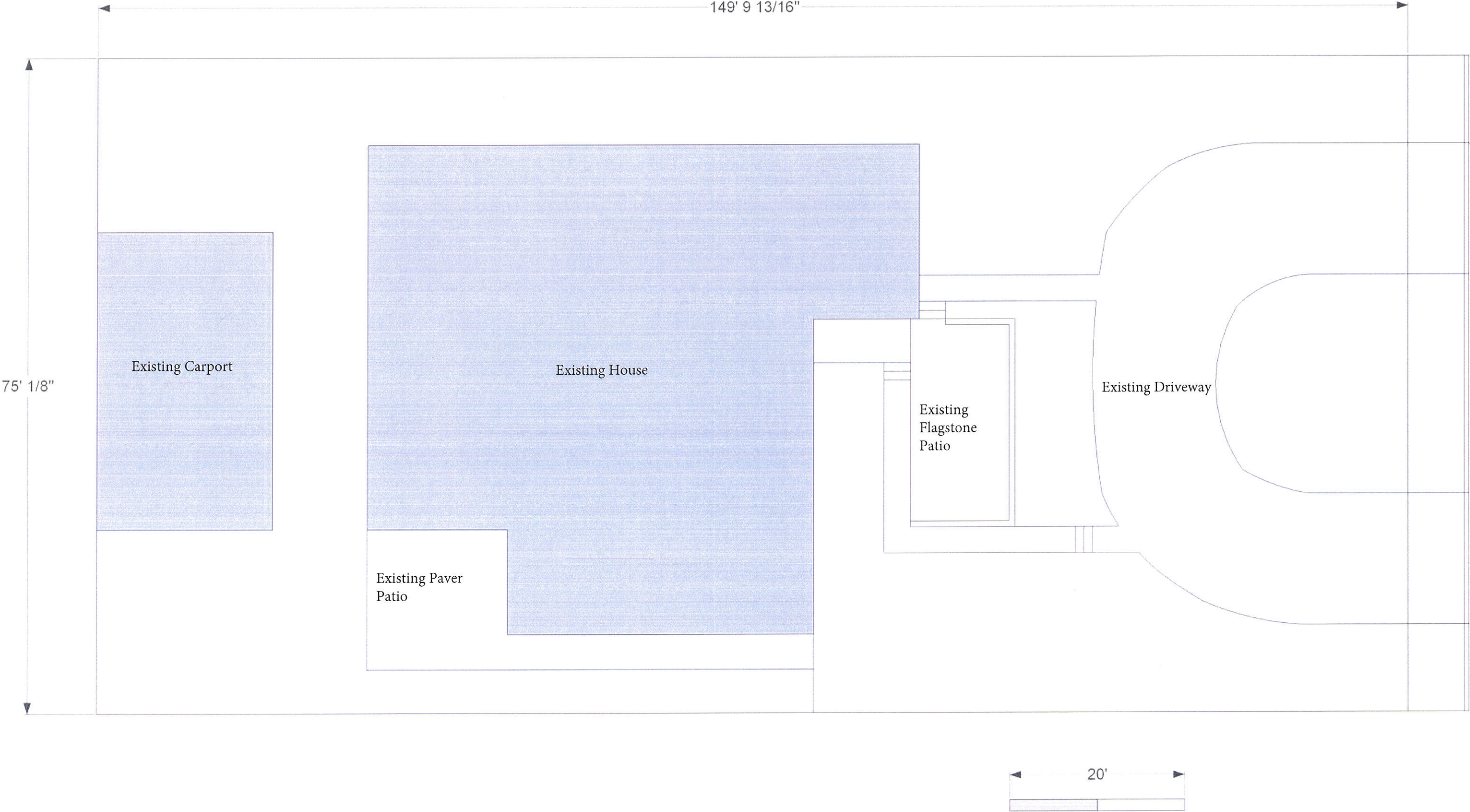

217 EAST OAKVIEW PLACE- PROPOSED CONDITIONS 9.17.2018

